

www.dhanaas.com



Wouldn't you like to give your children an environment
they would feel at home in?



No.3/367 D, "Vrikshaa", Sri Ramdev Garden, Nadupalayam Road, Pattanam, Coimbatore - 641 016,
Ph: 0422 2913244, 2913255 , E-mail : sales@dhanaas.com, Website : www.dhanaas.com

Isarus Media - 0422 4204474

The environment you are in contributes largely to defining not only who you are but also where you are going. For the young, the growing up years is vital. That is why it is imperative to provide the right space for them to find comfort and feel secure at all times.

MATHURA. INDEPENDENT VILLAS SET IN AN ENVIRONMENT OF PEACE AND TRANQUILITY.

Mathura offers all that it takes to give you a living experience that you and your family would cherish. The design is a revelation. Meticulous planning has gone into the design parameters so as to give you the comfort of spaciousness. In fact, detailing being our forte, we have spared no efforts to ensure even the smallest detail

in design and construction has not been left to chance. Your home is set amid lush greenery, as befitting the location, and there are well lit pathways and ample space outdoors for a wide range of activities. Each villa has a compound wall with gate and space for a private garden.

PAYMENT MODES

- | | |
|---|-------|
| 1. Initial Payment for Booking | : 10% |
| 2. Land Registration | : 20% |
| 3. Starting of Foundation Work | : 15% |
| 4. Starting of Ground Floor Brick Work | : 15% |
| 5. Starting of First Floor Brick Work | : 10% |
| 6. Starting of Plastering Work | : 10% |
| 7. Starting of Flooring, Electrical & Plumbing Work | : 10% |
| 8. Compound Wall Laying Fixing all Amenities & Painting | : 5% |
| 9. Handing Over | : 5% |

For booking please contact :

95853 99099

95854 99099

or mail us to sales@dhanaas.com

NOTE : Saleable area includes plinth area of the villas, including walls and external finish, utility area, balconies and proportionate share of all common areas, common amenities and services. Whilst every care has been taken in the preparation of this brochure, the promoter(s) reserve their rights to make alterations, amendments including additional constructions on the building / Property as may be necessitated / permitted from time to time. the promoter(s) reserve the rights to add / delete any facility, specification or amenity at the time of execution of the agreement of sale of the villas. This brochure does not form any inclusion in the legal documents and purely for information only.



LOCATION MAP



Dhanaas
Mathura
 Modern Independent Villas



LIFE BEYOND THE FOUR WALLS

You expect a lot more than just a home when you decide to invest in a residential complex. That is why we have thoughtfully included a wide range of activities, right on campus that you and your family can look forward to. A swanky swimming pool for you to cool off during the summer heat.

A shuttle court to get your body in shape. A gym if you are inclined to workout. There is also a jogging track for a morning or late evening walk or run. Extensive play areas have also been set up so that your children would have something to look forward when back from school. All other facilities you expect – security, power back up, RO Plant etc are integral to the project.



SPECIFICATION

- Structure** : Load Bearing Structure. Brick Wall Masonry And Plastering.
- Joineries** : Main Door Made Of Ornamental Designed Door with Teak Wood Frame. Other Doors Shall Be Flush Skin Type With Hard Wood Frame. One Side Of The Toilet Door Provided With Lamination.
- Windows** : Made Of UPVC Frame With Louvers.
- Ventilators** : Made Of UPVC Frame With Louvers.
- French Door** : Made Of Hard Wood Door With Shutters.
- Flooring** : Living, Dining, And Other Bedrooms - Vitrified 2'X2' Tiles. Kitchen, Toilet And Balcony – Non Skid Tiles. Car Parking – Granolithic Or Broken Mosaic / Marble Flooring.
- Wall Tiles** : Kitchen Ceramic Wall Tiles Above The Platform. Toilet – Ceramic Wall Tiles For 7'.0" Height From The Ground Level.
- Kitchen** : Kitchen Platform Provided With Granite. Stainless Steel Sink.
- Plumbing** : All Pipes Well Concealed Inside The Building. CPVC Pipeline For Hot Water And Solar Provision.
- Electrical** : Modular Switches With MCB. III Phase Electrical Line With Concealed Wiring And Fitting. TV And Telephone Point Shall Be Provided In The Living And Master, All Fittings Will Be ISI Equivalent Branded. A/C Provisions will be Provided in the Bedrooms.
- Painting** : All Inside Walls And Ceiling With Putty And Finished With Emulsion Paint Roller Finish.
- Exterior** : Weatherproof Emulsion Paint.



AMENITIES



Jogging Track



Private Garden



Artistically Done Elevation



24 X 7 Security



100% Power backup



Thar Road and Street Lights



Children's Play Area



Shuttle Court



Main Door Facing : West
 Area of Ground Floor : 857 sqft
 Area of First Floor : 835 sqft
 Total Built-up Area : 1692 sqft



GROUND FLOOR PLAN

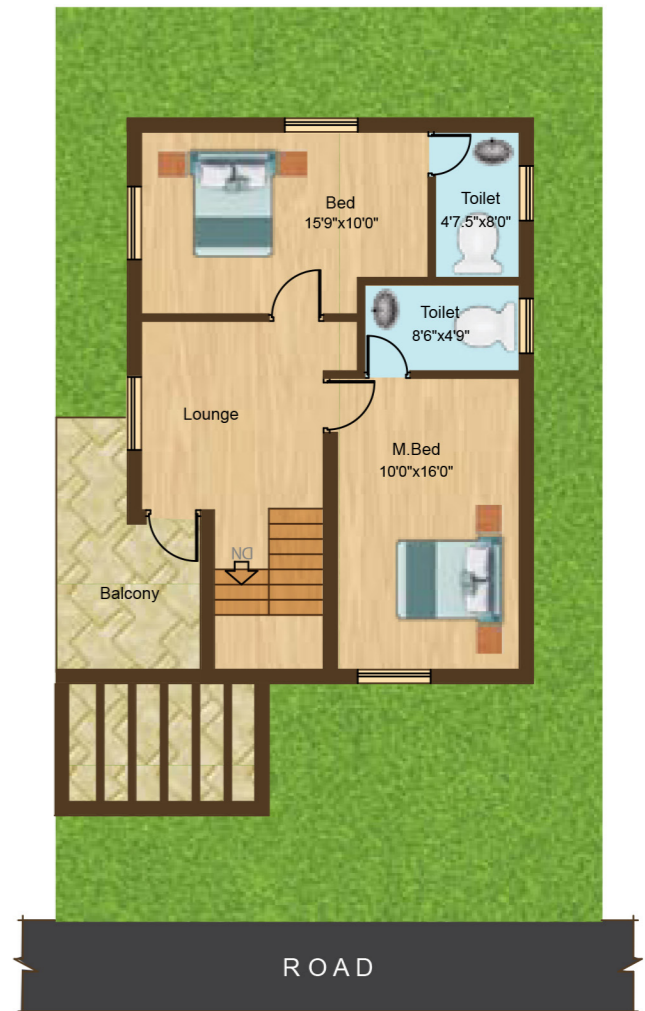

FIRST FLOOR PLAN



THE DHANAAS EXPERIENCE

With many prestigious projects to our credit, we have set the standard in building homes that bring comfort and well being through exemplary design and facilities that make people feel at home. All our projects are standing testimony to our prowess and commitment. No efforts are

spared to ensure that every home bears the unique Dhanaas signature of quality. Only the best materials are sourced from reputed suppliers and we look into even the smallest detail to ensure perfection. So when you move into a Dhanaas home you can do so with a sense of pride.



Main Door Facing : East
 Area of Ground Floor : 811 sqft
 Area of First Floor : 839 sqft
 Total Built-up Area : 1650 sqft



ROAD
GROUND FLOOR PLAN

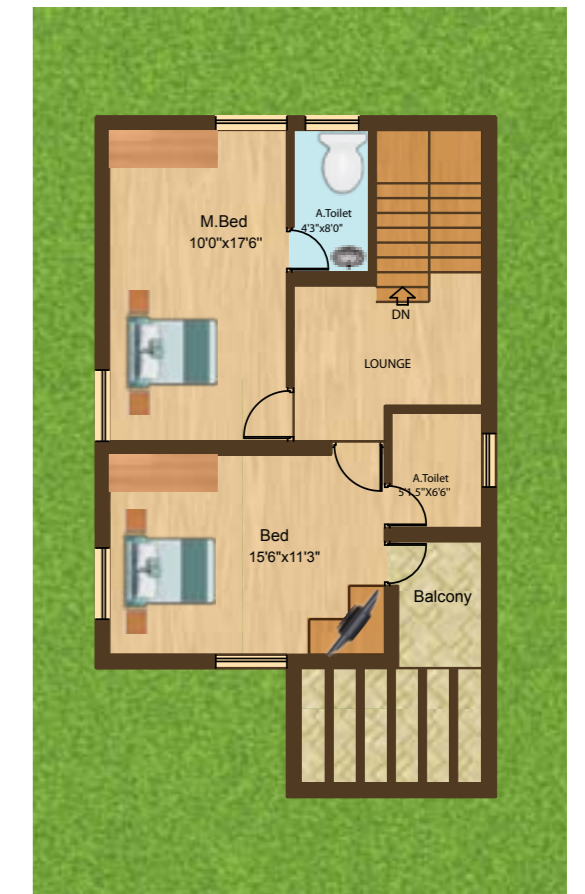

ROAD
FIRST FLOOR PLAN

